

STUD DIMENSIONS

FULL THREAD
(Measured end to end)

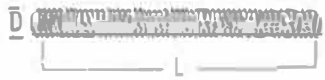

FULL THREAD
(Measured first thread to first thread
per ASTM A193/A320)



DOUBLE END

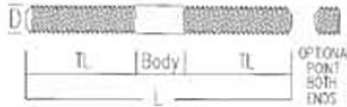

TAP END

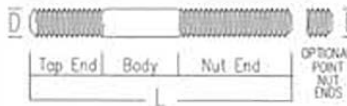

CHISEL POINT
45° POINT



REDUCING



Diameters: No. 2 to 4" • Lengths: As Specified • Unified Fils: 1A, 2A, 3A, 5 CSF, 5 ONF, 5 HF • Metric Fils: 8g, 9g, 4h

STANDARD STUD TYPES

Full Thread
Single End
Blank (Unthreaded)

Double End
Tap End
Radius End

Chisel Point
Reducing

NUT DIMENSIONS

ASF STANDARD PRODUCT TYPES

Hex
Heavy Hex

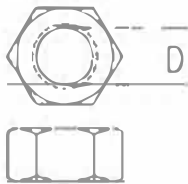

Hex Jam
Heavy Hex Jam

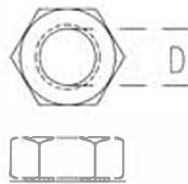

Slotted
Heavy Slotted

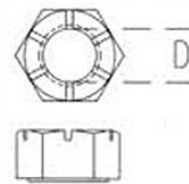

Square



Castle

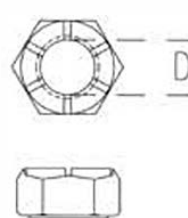

Flange

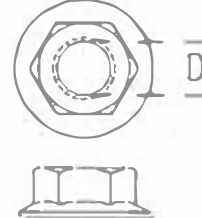

Order your Product Type with Diameter, Thread Pitch and Material

Quick Delivery is our Specialty!